



ADDENDA #1

Date: July 17, 2024

PROJECT:

St. Cloud HRA Northway Townhome B Exterior Renovation
2401-2445 15th St. No., St. Cloud, MN 56303

Make the following revisions to drawings and specifications previously issued.

GENERAL:

- Reminder: Bid Date is Thursday, August 8, 2024, at 2:00 p.m.
- Contractor is responsible to coordinate with utility providers prior to demolition/construction to verify process for moving or adjusting exterior utility equipment (cabling, boxes, etc.) to allow for siding installation.

SPECIFICATIONS:

064023 – Interior Architectural Woodwork.

1. Section has been revised. See attached.

072500 – Air Infiltration Barriers

1. Alternate products will be accepted if they meet the required specifications indicated in this Section.

074600 – Siding, Soffit and Fascia.

1. All fascia to be a “stepped” profile fabricated from coil stock and bent to match existing sub-fascia.

076200 – Sheet Metal Fabrications

1. Provide EDCO, E-Z Smooth Flow Gutter Guard, #3228-001, at all gutter locations.
2. All exterior door jambs and moldings to be wrapped in prefinished aluminum, to match other trim.
3. Garages for units 2401 and 2405 have existing gutters on the man-door side that will need to be replaced. No other garages have this condition.

083613 – Sectional Doors

1. Provide new jambs and weatherstripping at all sectional doors. Jambs to be 5/4 pvc material.

260000 – Electrical

1. Finish for all exterior light fixtures shall be “B” Bronze.

DRAWINGS

- **NOTE:** Contractor is responsible to verify all dimensions on-site. Dimensions on the Floor Plans and Schedules are based on available information and have not been verified.

A-104 – Basement Floor Plan.

1. 1/A-104 window label for unit 2401 on south side should be W-01, not W-02 as shown (same as unit 2405).

- 2/A-104 window label for unit 2429 on north side should be W-01 (illegible on plan).

A-105/A-106 – Floor Plans.

1. Front entry stoops are concrete and will not receive decking as indicated (shall remain “as is”).
2. 2/A-105 window labels for W-07 on south side should be 2'-8" x 2'-0" for all, not 2'-0" x 3'-0" as shown.
3. 2/A-105 window labels for units 2433, 2421, 2413 on north side should be W-06, not W-07 as shown.
4. 2/A-105 window label for unit 2429 on north side should be W-05, not W-02 as shown.
5. 2/A-106 window label for W-07 on north side should be 2'-8" x 2'-0" for all, not 2'-0" x 3'-0" as shown.

1/AS-001 & 8-12/A202 – Trash Enclosure.

1. Scope of work has changed at the Trash Enclosure. See attached 1/A-602.1 & 1/A-602.2.

APPROVALS

Section	Item	Manufacturer
(None)		



Lon D. Negen, AIA, CID, LEED AP
Principal
Registration Number 41402

SECTION 064023 - INTERIOR ARCHITECTURAL WOODWORK

PART 1 - GENERAL

1.1 SUMMARY

A. Section Includes:

1. Interior wood trim.

B. Related Sections:

1. Section 099100 "Painting", for shop painting of interior architectural woodwork.

1.2 ACTION SUBMITTALS

A. Shop Drawings:

1. Include the following:

- a. Dimensioned plans, elevations, and sections.
- b. Attachment details.

- B. Samples:** For each exposed product and for each shop-applied color and finish specified.

1.3 QUALITY ASSURANCE

- A. Fabricator Qualifications:** Company specializing in fabricating wood trim finish work with a minimum of 3 years of experience, and complying with AWI's Quality Certification standards.

- B. Installer Qualifications:** Company specializing in installing wood trim finish work with a minimum of 3 years of experience, and complying with AWI's Quality Certification standards.

- C. Mockups:** If required, build mockups to verify selections made under sample submittals, to demonstrate aesthetic effects, and to set quality standards for materials and execution.

1. Approval of mockups does not constitute approval of deviations from the Contract Documents contained in mockups unless Owner specifically approves such deviations by Change Order.

PART 2 - PRODUCTS

2.1 ARCHITECTURAL WOODWORK, GENERAL

- A. Quality Standard:** Unless otherwise indicated, comply with the "Architectural Woodwork Standards" for grades of interior architectural woodwork indicated for construction, finishes, installation, and other requirements.

2.2 INTERIOR STANDING AND RUNNING TRIM

A. Architectural Woodwork Standards Grade: Custom.

B. Species: Poplar

1. **Cut: Plain sliced/plain sawn.**
2. **Finger Jointing: Not allowed.**

C. Moulding Patterns: MMPA, “WM/Series Wood Moulding Patterns”.

1. **Casing Pattern: ~~WM412 11/16” x 3-1/2”~~ WM315 11/16” x 2-1/2” Ranch casing, or similar to match existing.**
2. **Finish: Painted.**

2.3 MATERIALS

A. Materials, General: Provide materials that comply with requirements of referenced quality standard for each quality grade specified unless otherwise indicated.

B. Wood Moisture Content: 5 to 10 percent.

C. Fasteners: Nails, screws, and other anchoring devices of type, size, material, and finish required for application indicated to provide secure attachment, concealed where possible.

D. Glue: Aliphatic-resin, polyurethane, or resorcinol wood glue recommended by manufacturer for general carpentry use.

E. Multipurpose Construction Adhesive: Formulation complying with ASTM D 3498 that is recommended for indicated use by adhesive manufacturer.

2.4 FABRICATION

A. Fabricate interior architectural woodwork to dimensions, profiles, and details indicated.

1. Ease edges of solid wood members 1/16 inch unless otherwise indicated.

B. Complete fabrication, including assembly, to maximum extent possible before shipment to Project site.

1. Disassemble components only as necessary for shipment and installation.
2. Where necessary for fitting at site, provide allowance for scribing, trimming, and fitting.

2.5 SHOP FINISHING

A. Preparations for Finishing: Comply with the “Architectural Woodwork Standards” for sanding, filling countersunk fasteners, sealing concealed surfaces, and similar preparations for finishing interior architectural woodwork, as applicable to each unit of work.

B. Finish interior architectural woodwork as indicated on Drawings at fabrication shop. Defer only final touchup and cleaning until after installation.

PART 3 - EXECUTION

3.1 PREPARATION

- A. Before installation, condition interior architectural woodwork to humidity conditions in installation areas for a minimum of 24 hours unless longer conditioning is recommended by manufacturer.

3.2 INSTALLATION

A. Standing and Running Trim:

- 1. Install trim with minimum number of joints as is practical, using full-length pieces from maximum lengths of lumber available.
 - a. Do not use pieces less than 24 inches long, except where necessary.
 - b. Stagger joints in adjacent and related standing and running trim.
 - c. Miter at outside corners, and cope at inside corners to produce tight-fitting joints with full-surface contact throughout length of joint.
 - d. Use scarf joints for end-to-end joints.
 - e. Plane backs of casings to provide uniform thickness across joints where necessary for alignment.
 - f. Install without splitting; drill pilot holes before fastening where necessary to prevent splitting.
 - g. Fasten to prevent movement or warping.
 - h. Countersink fastener heads on exposed carpentry work and fill holes.

END OF SECTION 064023

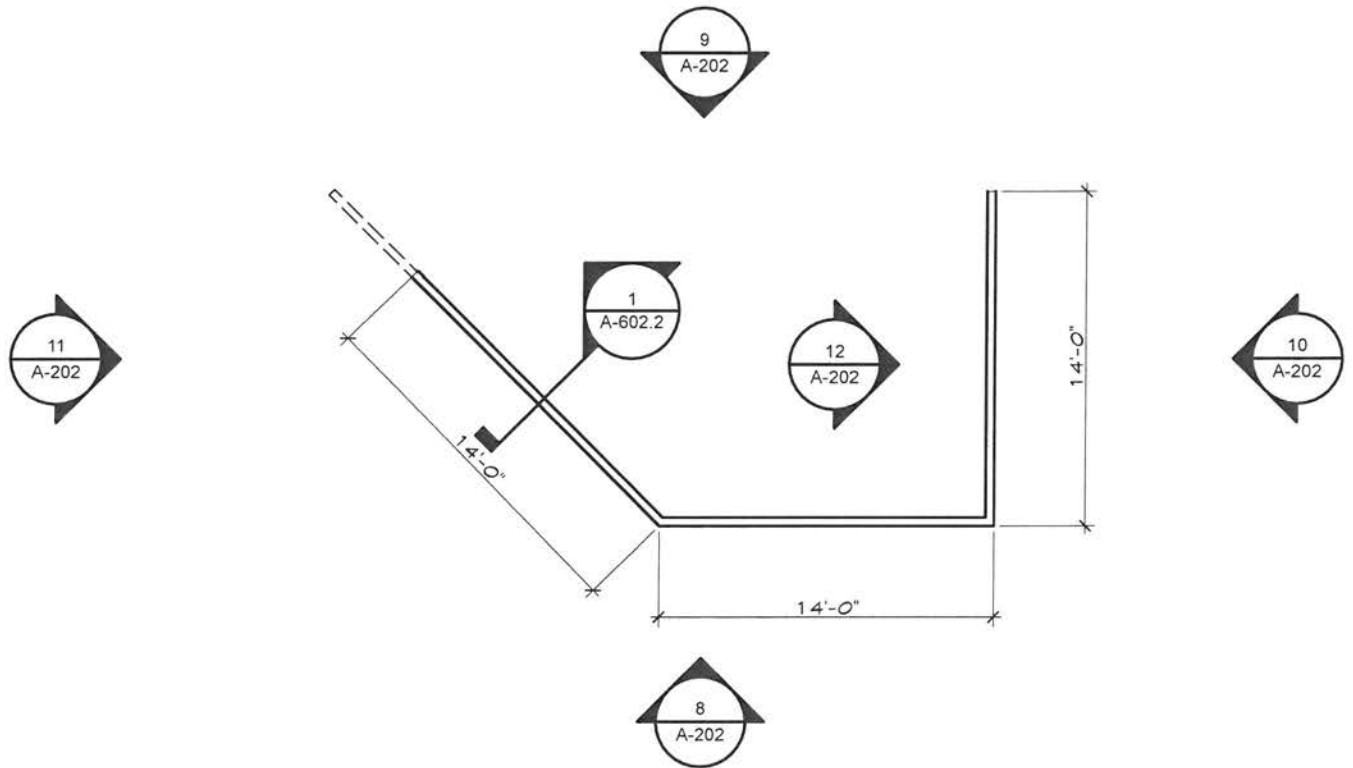

1
A-602.1

Trash Enclosure Plan

SCALE: 1/8" = 1'-0"



NEGEN
Architecture | Interior Design | Planning

STUDIO 700 41st Avenue North
St. Cloud, Minnesota USA 56303
TELEPHONE 202 251 3304
WEB www.negenarchitects.com

**St. Cloud HRA Northway
Townhome "B" Exterior
Renovation**

2401-2445 15th St. N.
St. Cloud, MN 56303

Trash Enclosure Plan

REVISION

DATE

© 2024 Negen and Associates, St. Cloud, MN 56303

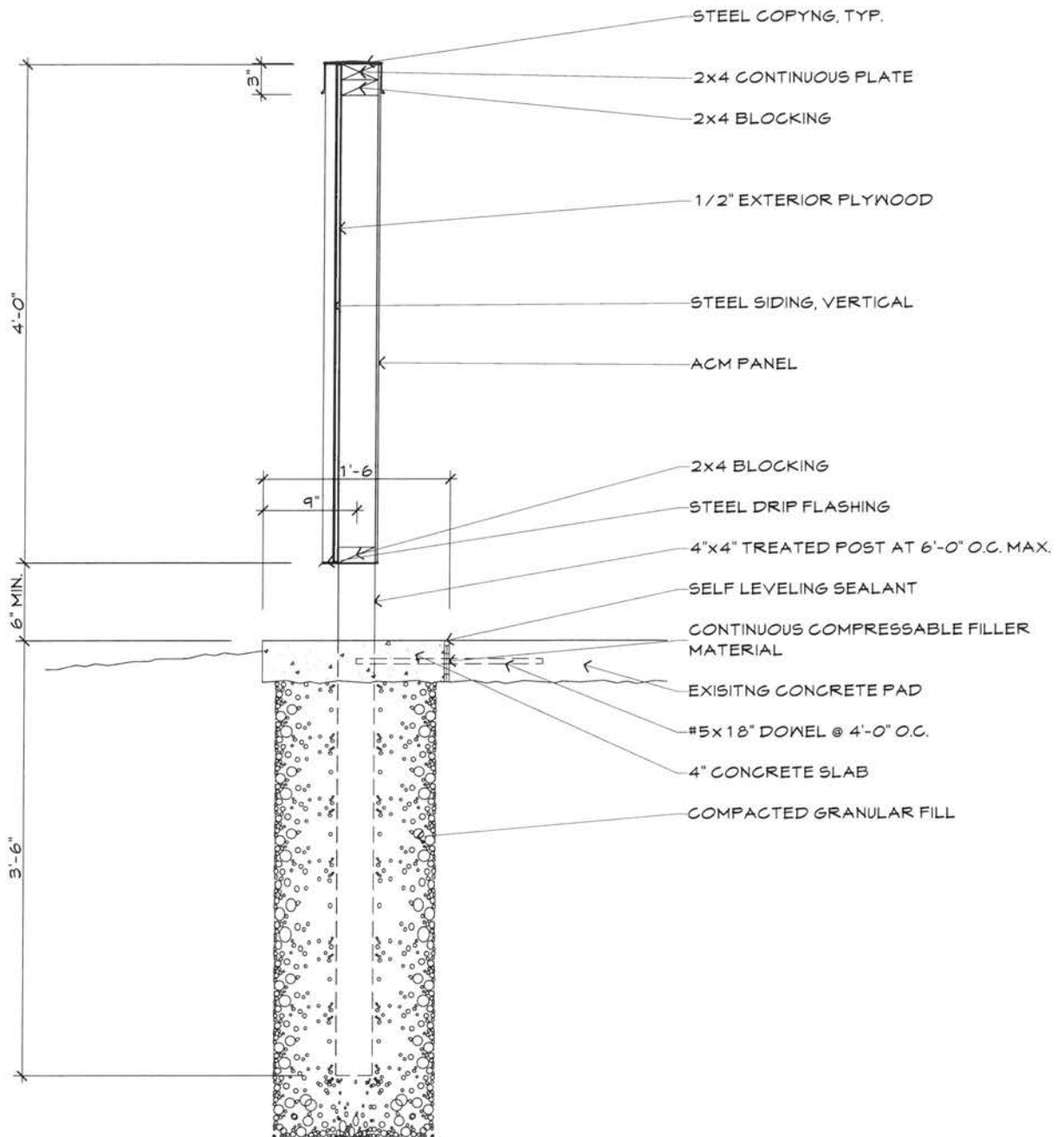

1
A-602.2

Wall Section

SCALE: 3/4" = 1'-0"



NEGEN
Architecture | Interior Design | Planning

STUDIO 700 41st Avenue North
St. Cloud, Minnesota, USA 56303
TELEPHONE 320.751.3304
WEB www.negararchitects.com

**St. Cloud HRA Northway
Townhome "B" Exterior
Renovation**

2401-2445 15th St. N.
St. Cloud, MN 56303

Trash Enclosure
Section

REVISION

DATE

© 2024 Negen and Associates, St. Cloud, MN 56303